

R-TECH TIG400EXT 400AMP AC/DC 415V DIGITAL TIG WELDER SPECIFICATIONS

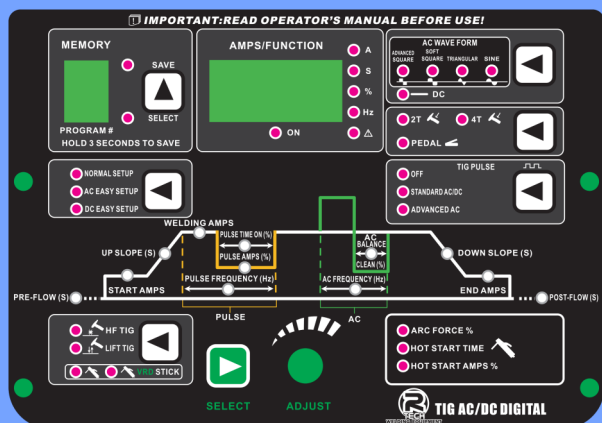

The R-Tech Digital TIG400EXT is a 400A AC/DC TIG welder with 415V input, 4 x AC Waveforms, power factor correction, HF arc starting, pulse welding, slope up/down, Digital LED display, 60% duty cycle and a remote foot pedal option



Digital control panel designed for easy setup & control of all weld parameters, a professional machine ideal for beginners and advanced users

- 9 Job auto memory store
- Power Factor Correction - Gives lower running costs and higher energy efficiency, cleans noisy power supplies & is 100% generator friendly
- Fan on demand cooling fan system
- 4 AC Waveforms

Square Wave: fast cooling weld pool, deep penetration and fast travel speed

Soft square & Sine Wave: Low arc noise, for a traditional arc

Triangular Wave: designed for thin alloys, reduces heat input

- HF Micro-Start for improved arc starting and less interference - Lift start option
- Amperage Range: 5 to 400 Amps (DC TIG)
- Amperage Range: 10 to 400 Amps (AC TIG)
- Amperage Range: 20 to 315 Amps (Stick)
- AC Frequency: 15-250Hz
- Pulse width: 5-95%
- Duty Cycle at 40°C: 60% @ 400Amps (TIG)
- Input voltage: 415v (Fuse Rating: 32 Amps)
- Pulse Freq. AC: 0.1-10Hz Soft, Sine & Triangular
- Pulse Freq. AC 0.1-250Hz Adv. Squarewave
- Pulse Frequency DC: 0.1-500Hz
- Dimensions: 660 x 280 x 550 mm Weight: 34kg
- VRD Voltage Reduction in MMA - reduces OCV in standby for increased user safety
- Full 4-way functioning with control of pre/post flow gas, initial/final amps, slope up/down
- Generator Friendly - Rec. minimum size: 10KVA
- LED displays for pre-set and actual amps
- MMA Anti-Stick & Hot Start technology
- Remote Foot Pedal Option
- Package includes: WP26 TIG Super-Flex torch (4m), earth lead & clamp, gas hose, regulator & owners manual

3 Year Warranty

ORDER ONLINE @
www.r-techwelding.co.uk

ORDER BY PHONE
01452 733933